



LED Light kit

USER'S GUIDE

Part Numbers: 180H/200H

Specifications	
Operating Voltage	3 volts
Remote Operating Distance	Up to 30 feet
Remote control type	Infrared Remote

1. Hardware Parts List

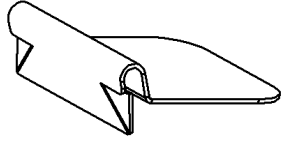
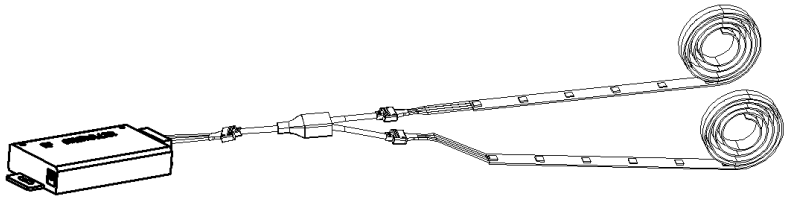
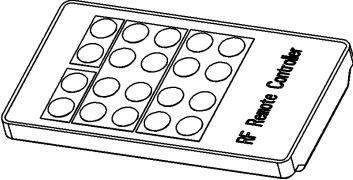
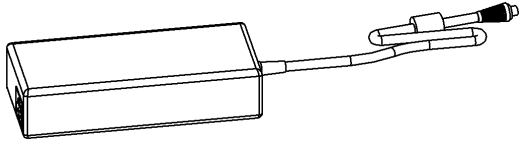
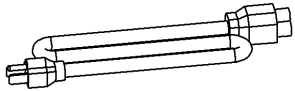
<p>A. LED clip</p> 	<p>B. LED Strip+ Controller</p> 	
<p>C. Remote Control</p> 	<p>D. Power Supply</p> 	<p>E. Power Cord</p> 

2. LED Light Assembly:

Step 1. Peel off the back to expose the adhesive.

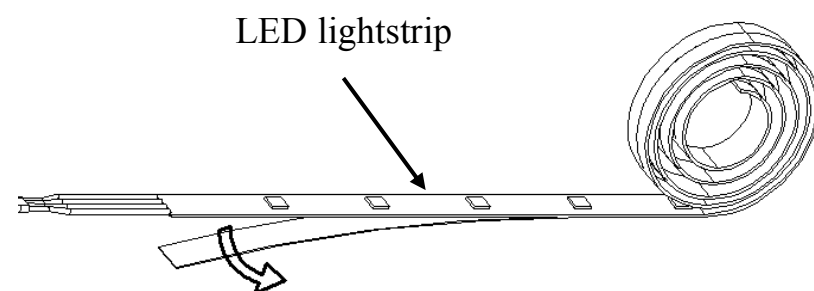

Step 2. Stick the LED light strip on the back of the frame slowly and smoothly. Continue all along the entire frame.

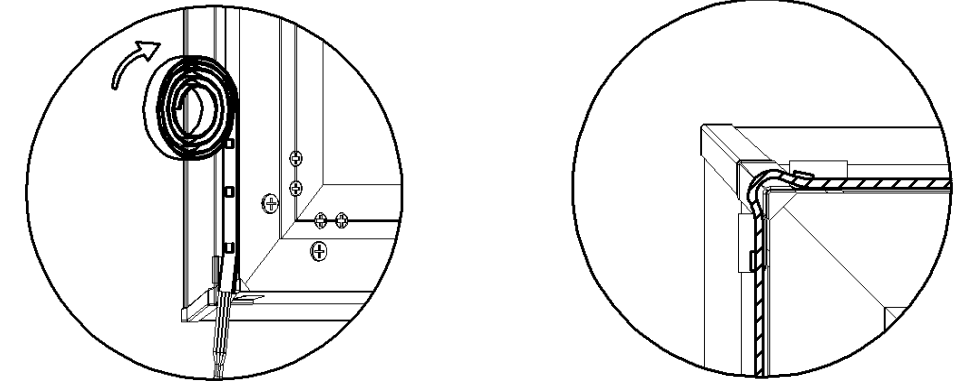

Step3. Secure the LED light strip by using the LED clips as shown below.

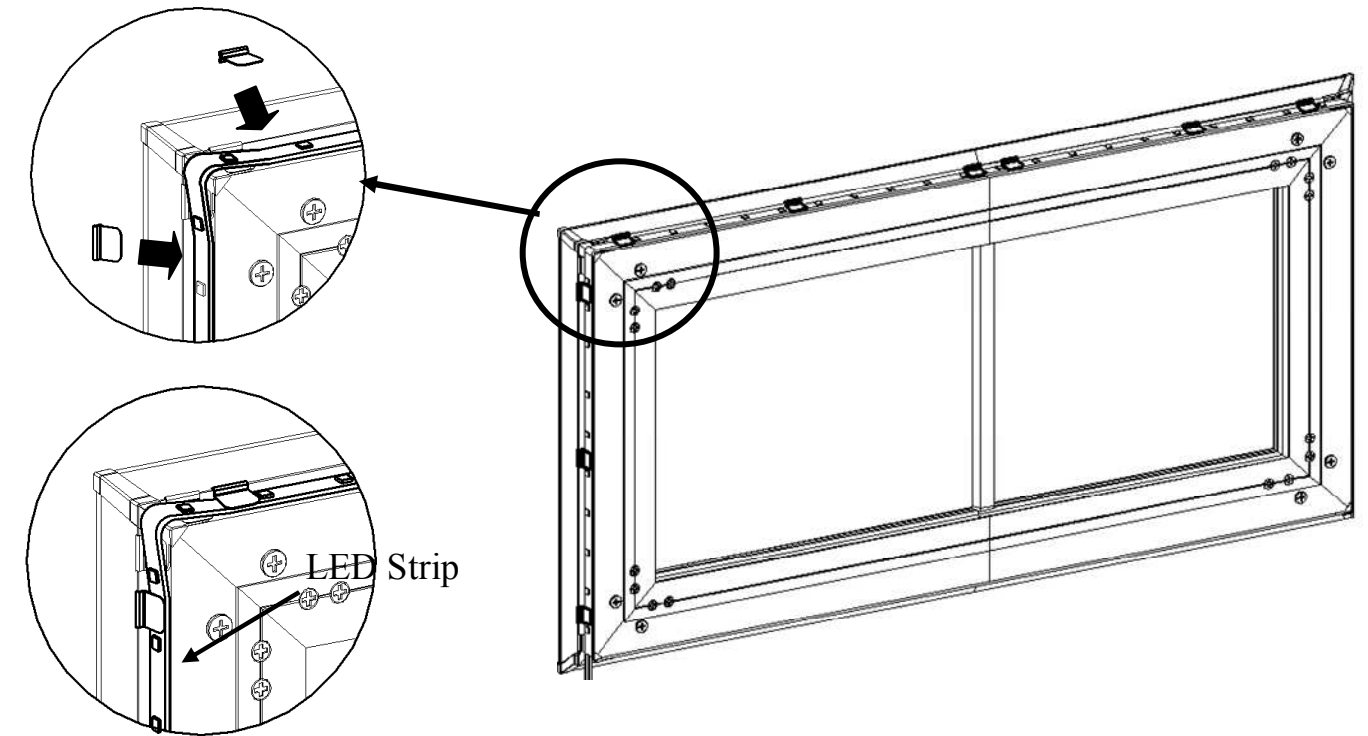

Step 4. Plug the Power Cord to the Power Supply

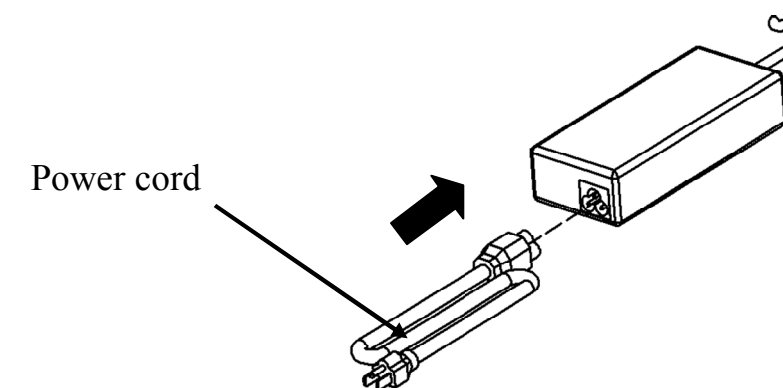

Step 5. Connect the LED Controller to the Power Supply

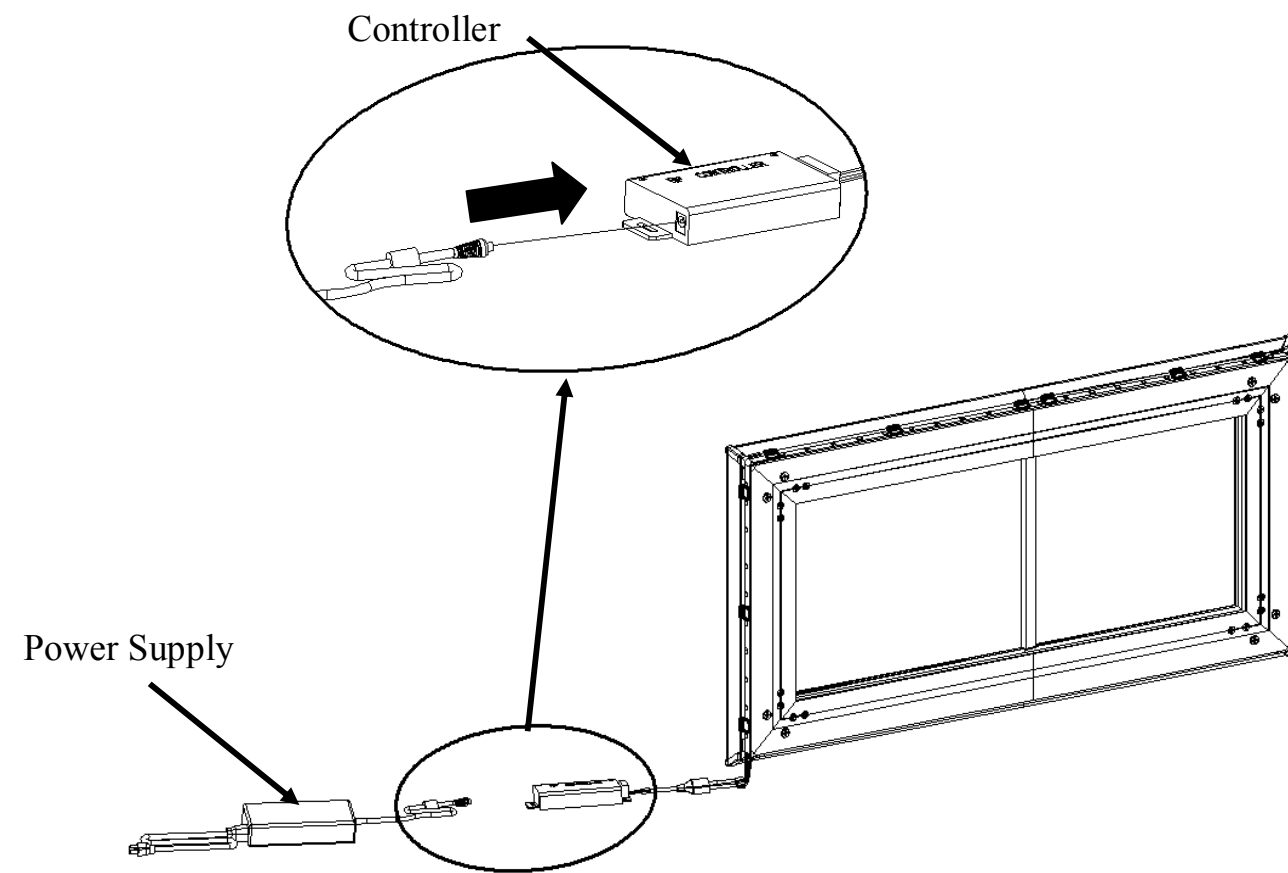

Step 6. Remote Control Operations

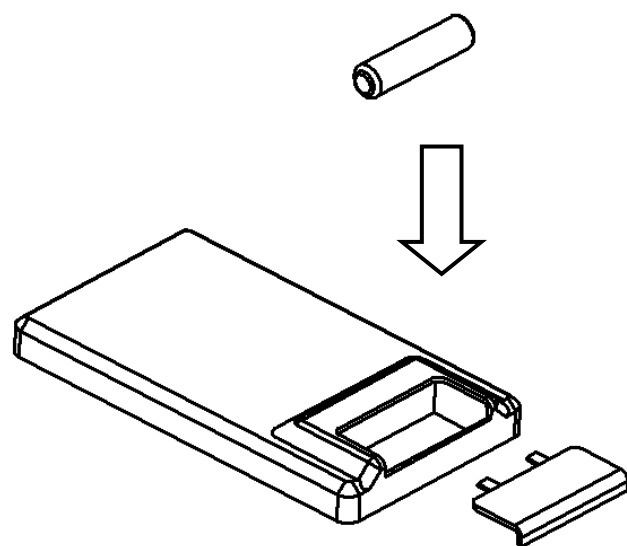

Please insert the batteries first



Button	Button Description	Remarks
	ON / OFF	Turns the LED lights on or off
	Play / Stop	Plays or Stops the Lights
	Brightness Increase	This key increases the brightness of the LED lights.
	Brightness Decrease	This key decreases the brightness of the LED lights.
AUTO	Automatic	Changes all of the modes to automatic
JUMP 3	3 Color step change	Speed and brightness are adjustable.
FADE 3	3 Color fade change	Speed is adjustable, brightness is not adjustable.
SPEED +	Speed increase	This will increase the speed of LED sequence
FLASH	7 Color flash sequence	Speed and brightness are adjustable.
JUMP 7	7 Color step sequence	
FADE 7	7 Color fade sequence	Speed is adjustable, brightness is not adjustable.
SPEED -	Speed decrease	This will reduce the speed of LED sequence

For Technical Support or an Elite Prime Vision contact in your area, visit

www.epvscreens.com